

COUPE A-A

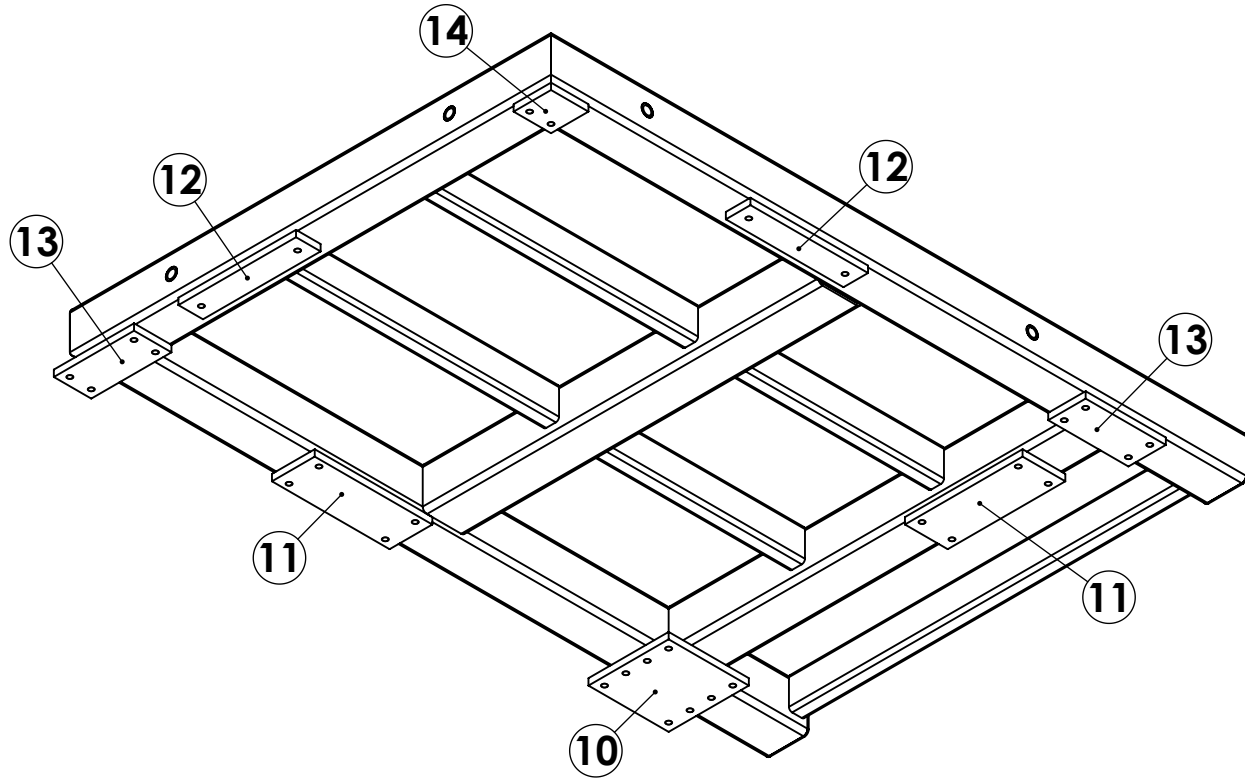

No.	QTE	DESCRIPTION	LONG.
1	1	Tube rectangulaire 80X80X4	1300
2	1	Tube rectangulaire 80X80X4	1300
3	1	Tube rectangulaire 80X80X4	900
4	2	Tube rectangulaire 80X80X4	740
5	1	Tube rectangulaire 60X30X3	740
6	2	Tube rectangulaire 60X30X3	500
7	2	Tube rectangulaire 60X30X3	380
8	2	Bouchon 160x80x2	
9	4	Tube 15x21 L:80	
10	1	Platine 150x150x12 Detail A	
11	2	Platine 220x80x12 Detail B	
12	2	Platine 220x46x12 Detail C	
13	2	Platine 150x70x12 Detail D	
14	1	Platine 70x70x12 Detail E	

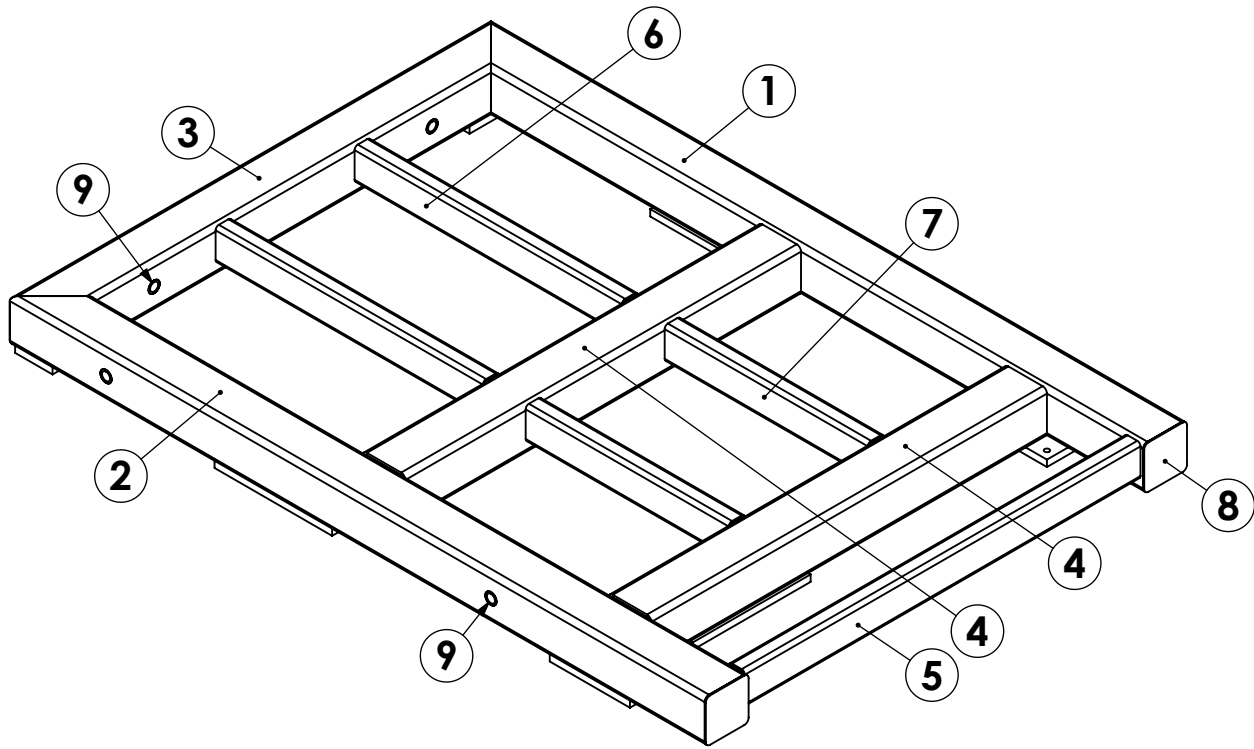
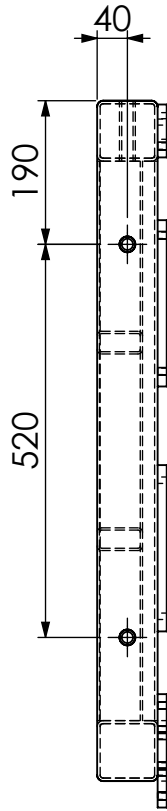
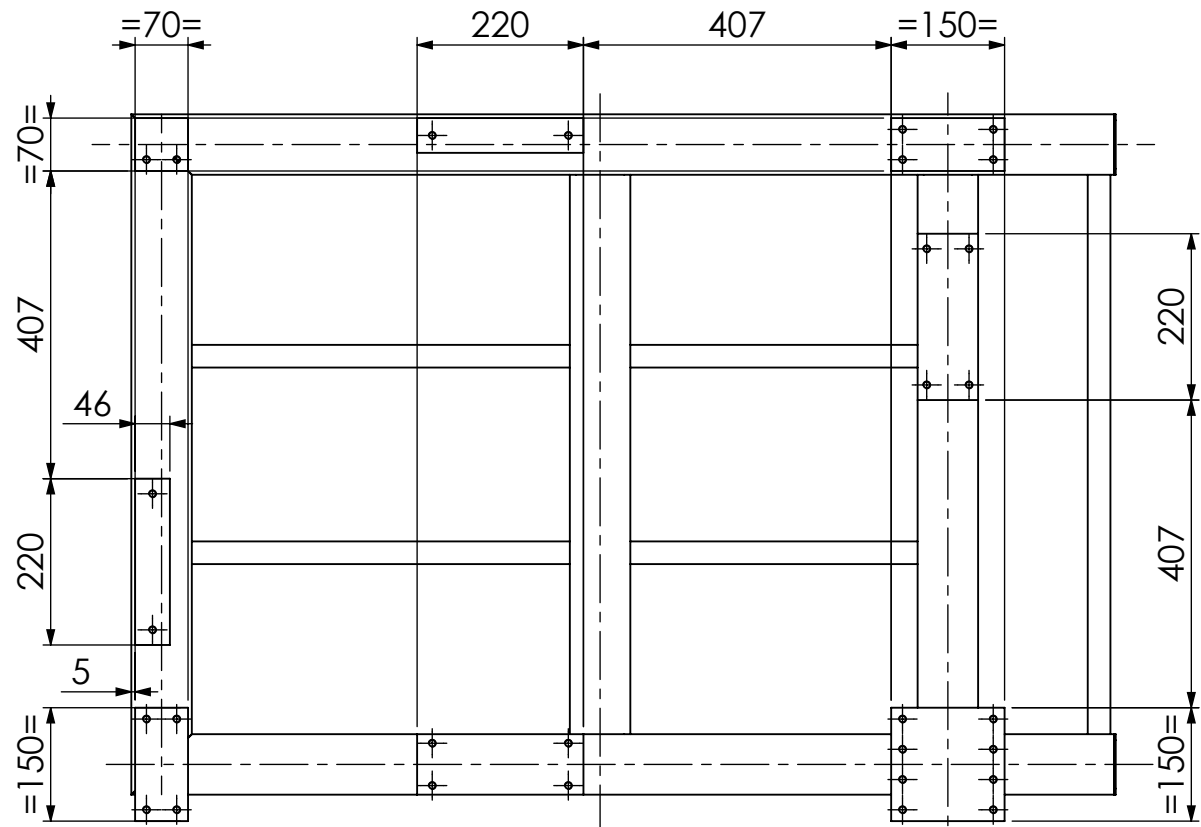
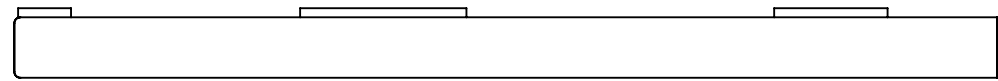
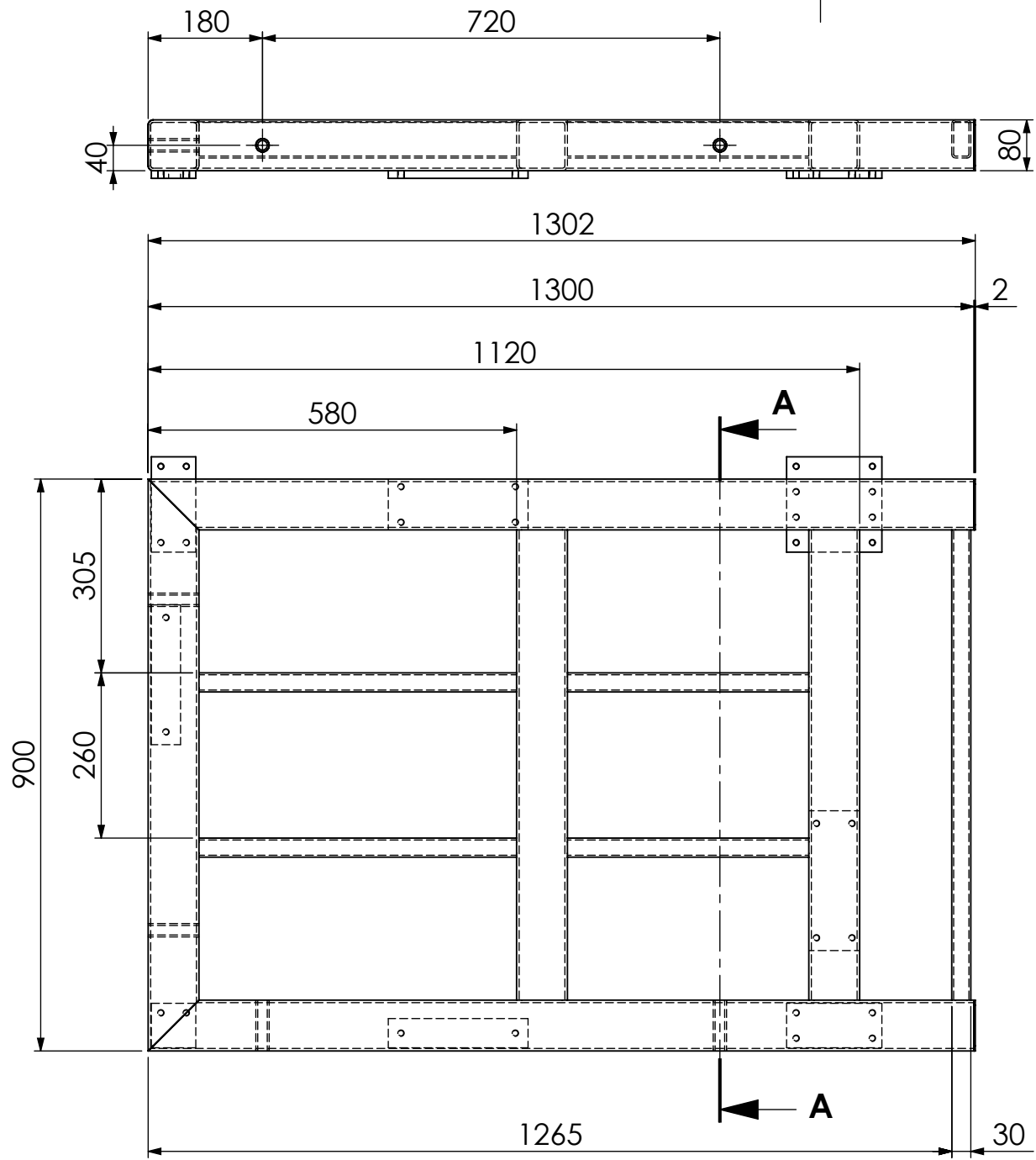
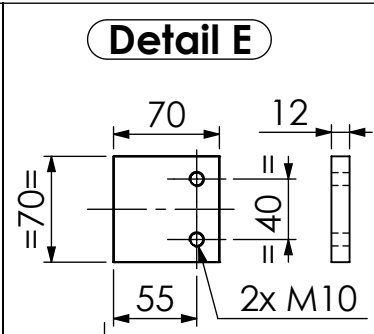
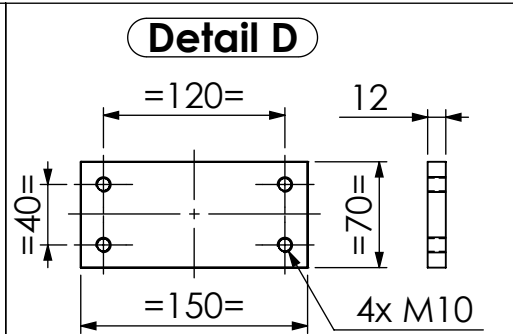
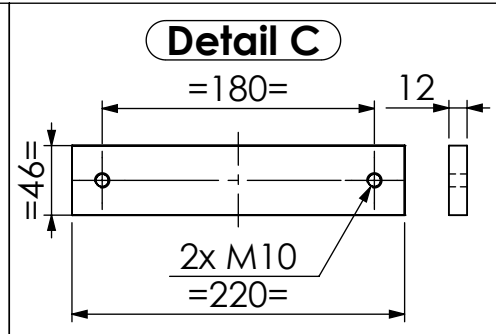
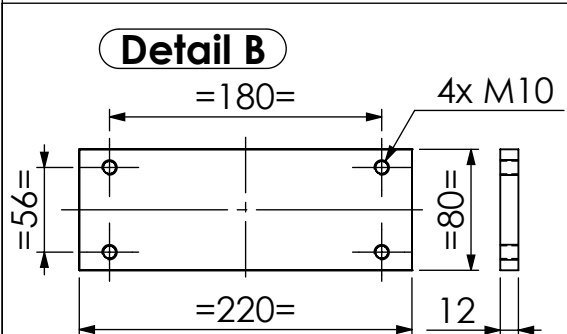
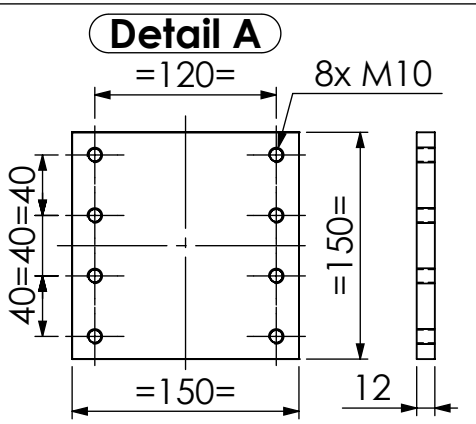

FOLIO 4/5

SOUDURES : A=3 CONTINUE ETANCHE
TOLERANCE GENERALE : ± 1 mm
TOLERANCE DE PLANEITE : ± 1 mm/m
PEINTURE EPOXY EP: 60 μ
COULEUR : BLANC RAL 9010

Ind. F		
Ind. E		
Ind. D		
Ind. C		
Ind. B		
Projet : CHASSIS CHAMP15		Masse : 63.64 Kg
Désignation : CADRE 4		Matière : E24-2
		Traitement :
		Rug. géné.:
		Tol. géné.: ISO2768 m K
5 place de Gordes 38000 Grenoble		Echelle:1:10 Format:A2 Feuille 1 / 1
Tel : 06 33 31 88 11 e-mail : heyman@design-mecanique.fr		date de création : 28/03/2024
Nom de fichier :FAU-CHAMP15-02 Folio 4		Indice
N° de plan		CHAMP15-FAU-02