

Detail
Ech:1/5

Platine 100x50x10 Detail A

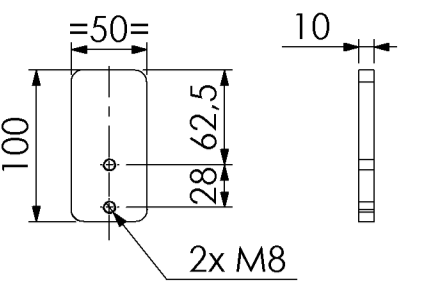

Platine 100x50x10 Detail B

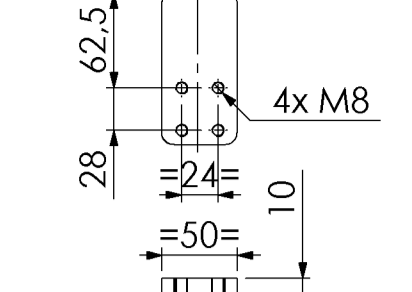

Platine 150x46x12 Detail C

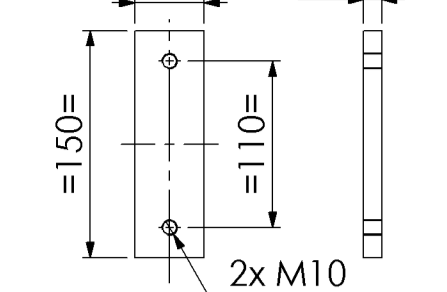

Platine 100x60x10 Detail D

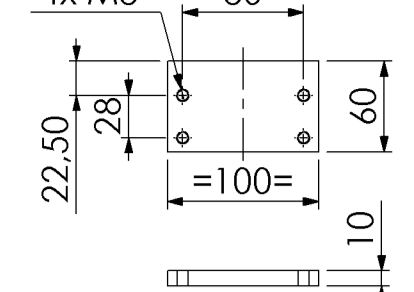

Douille M12 Detail E

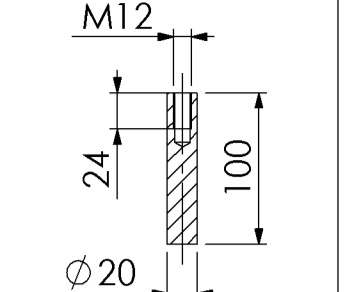

Tube 15x21 Lg:50 Detai F

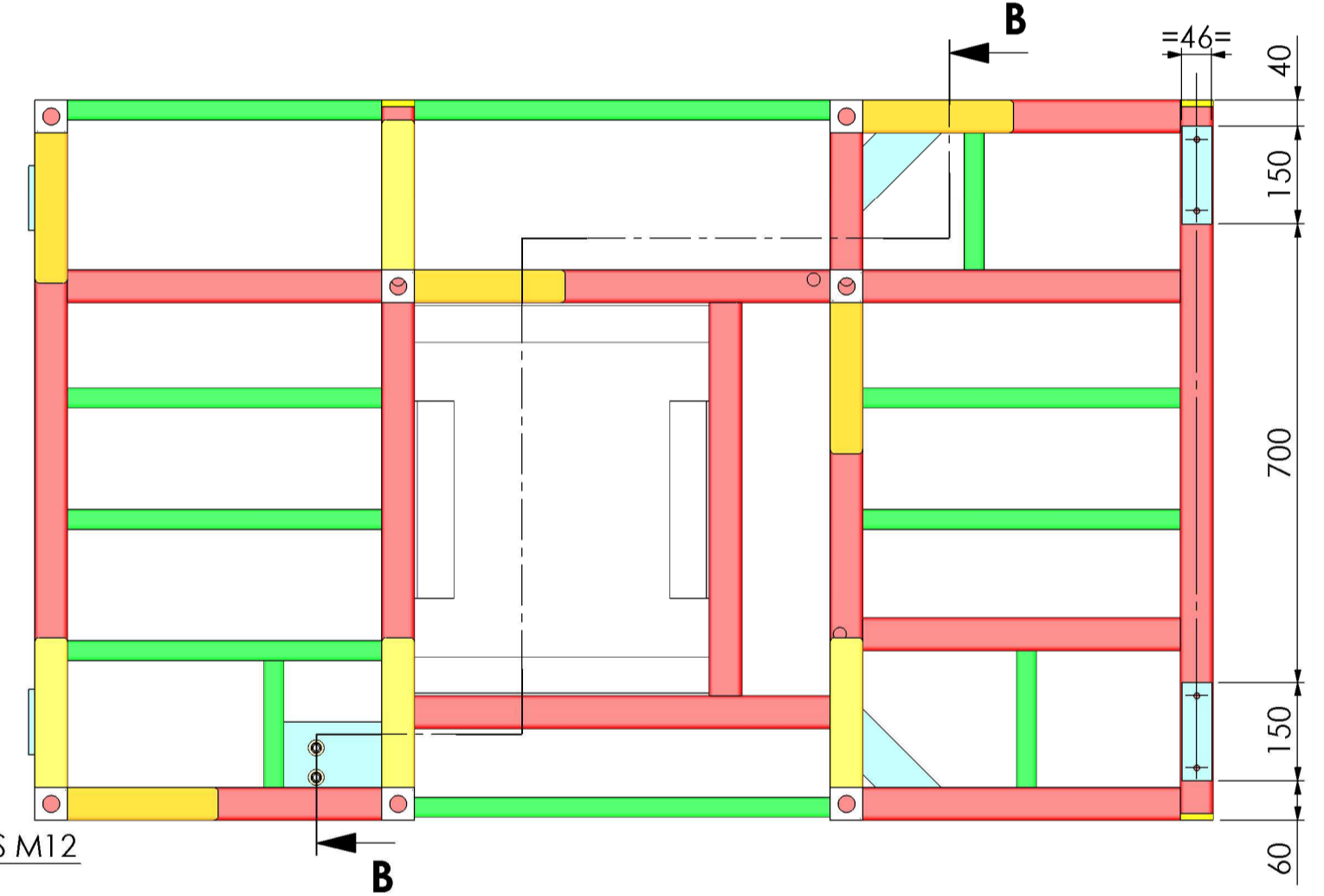
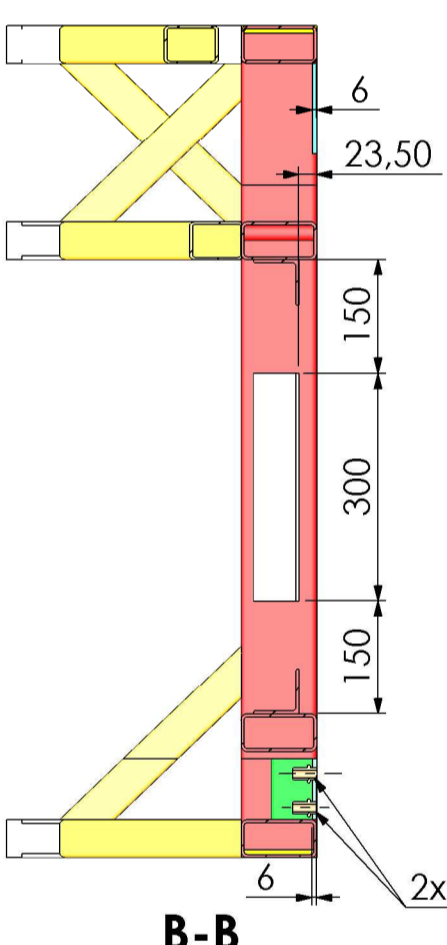
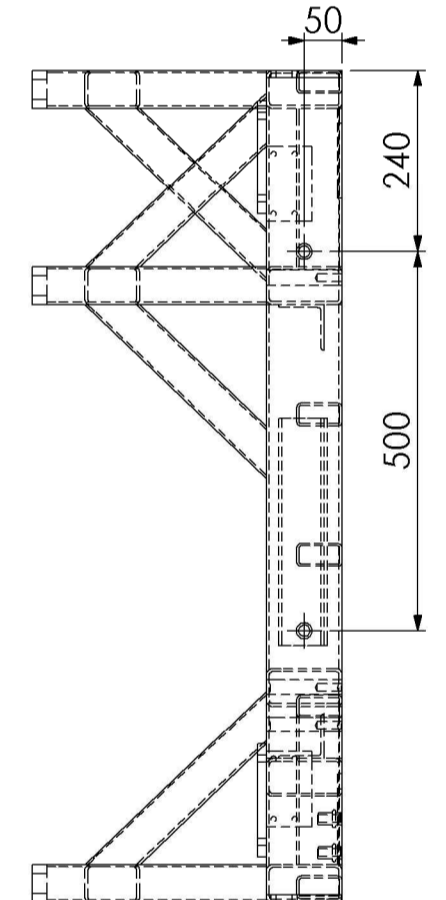
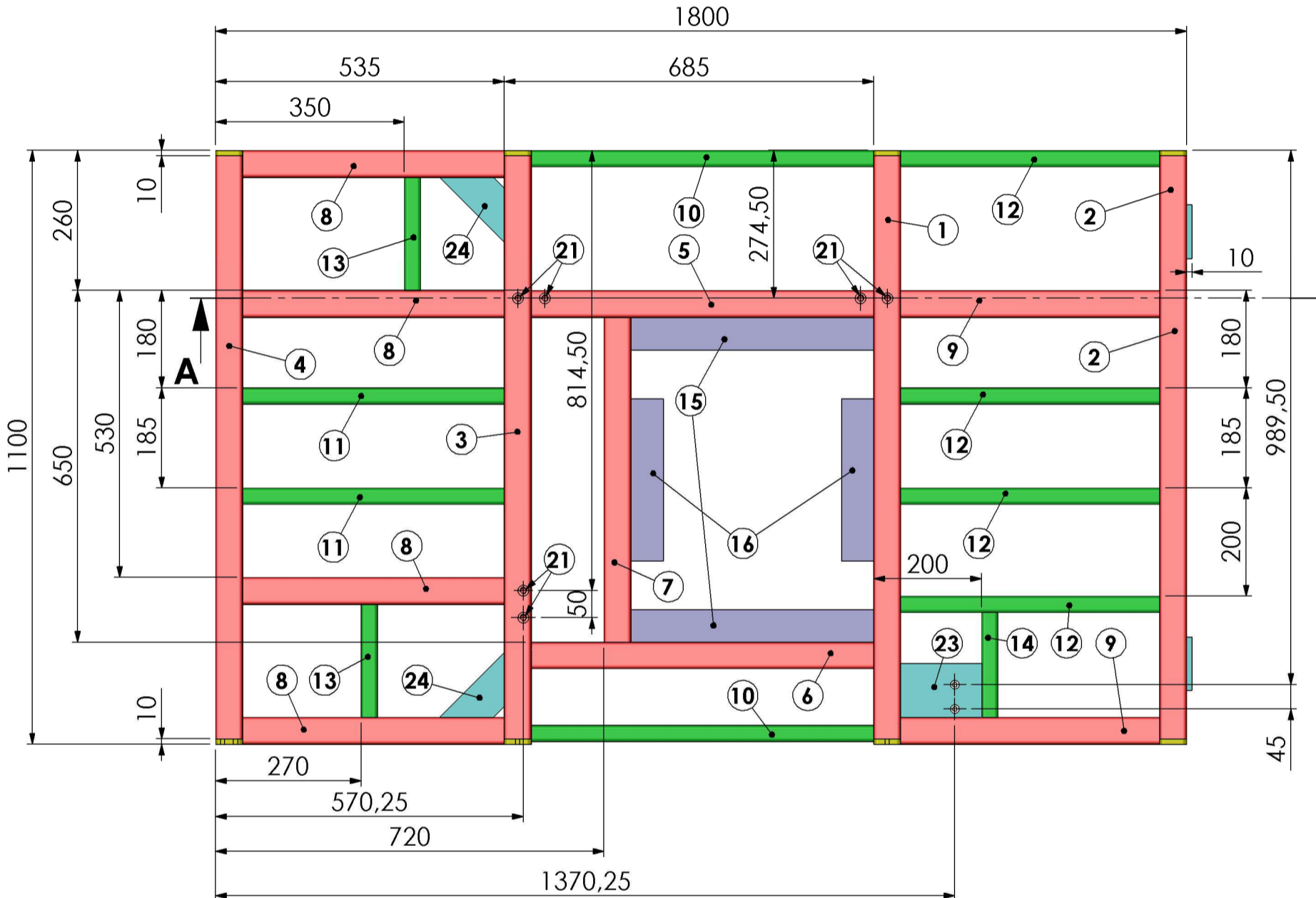
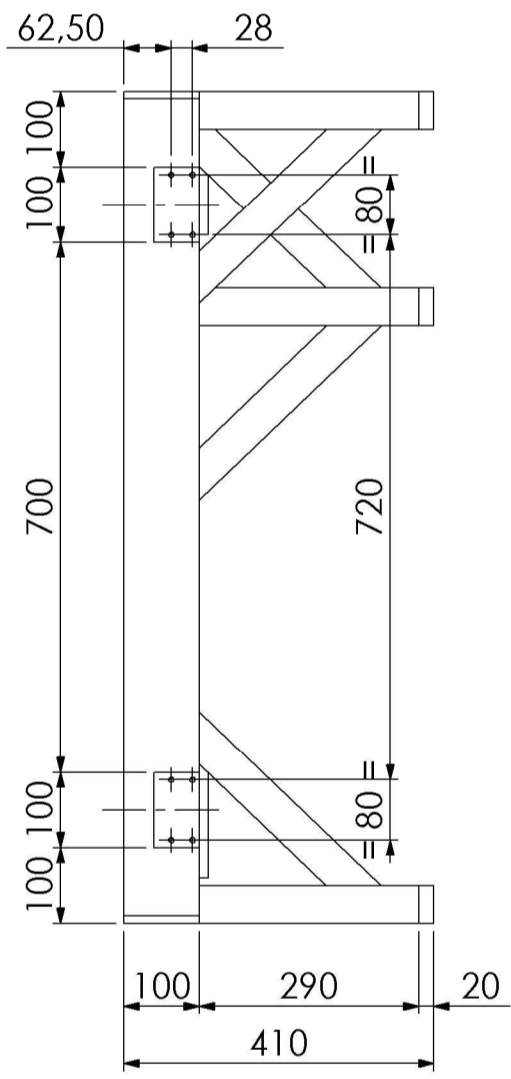
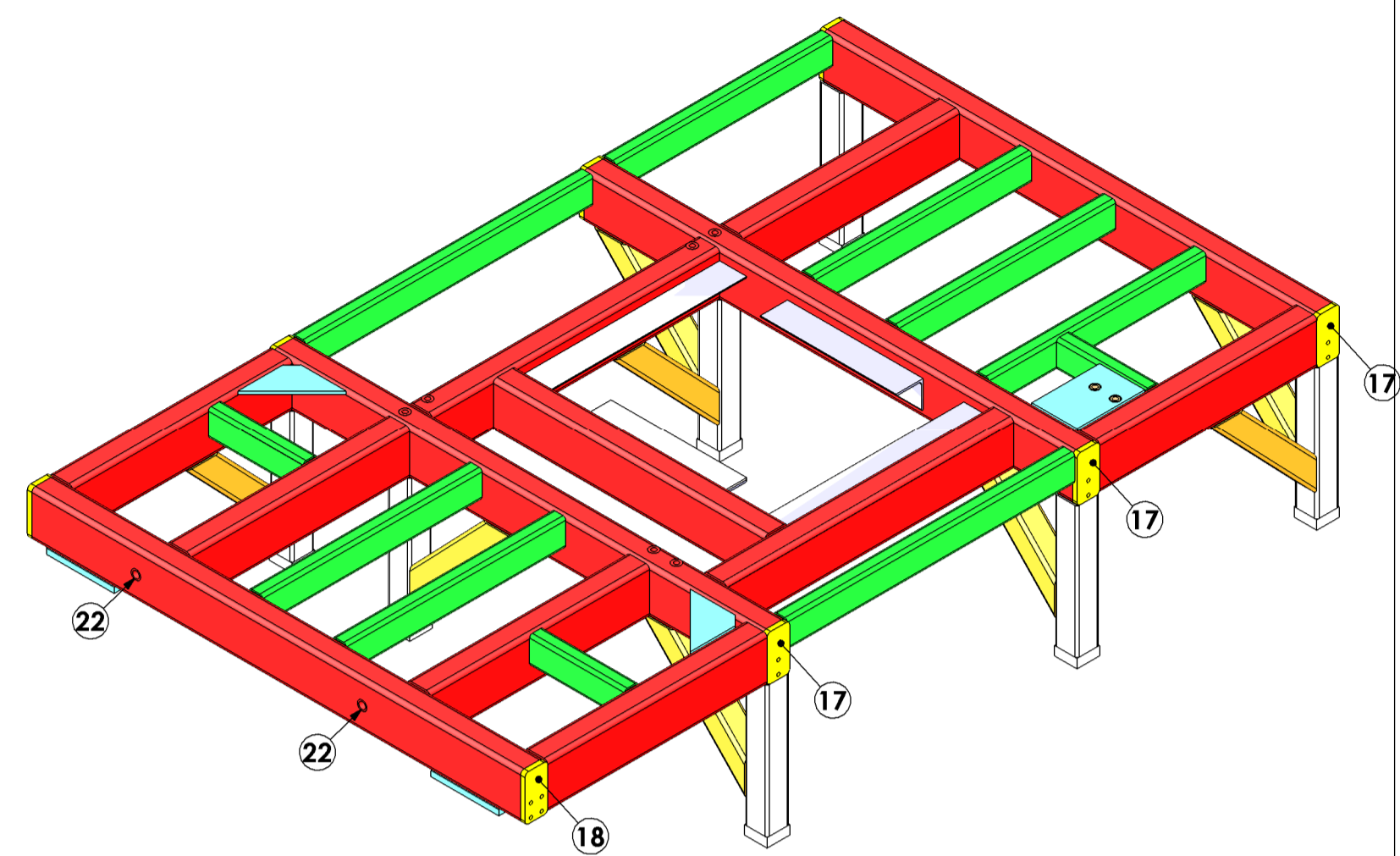
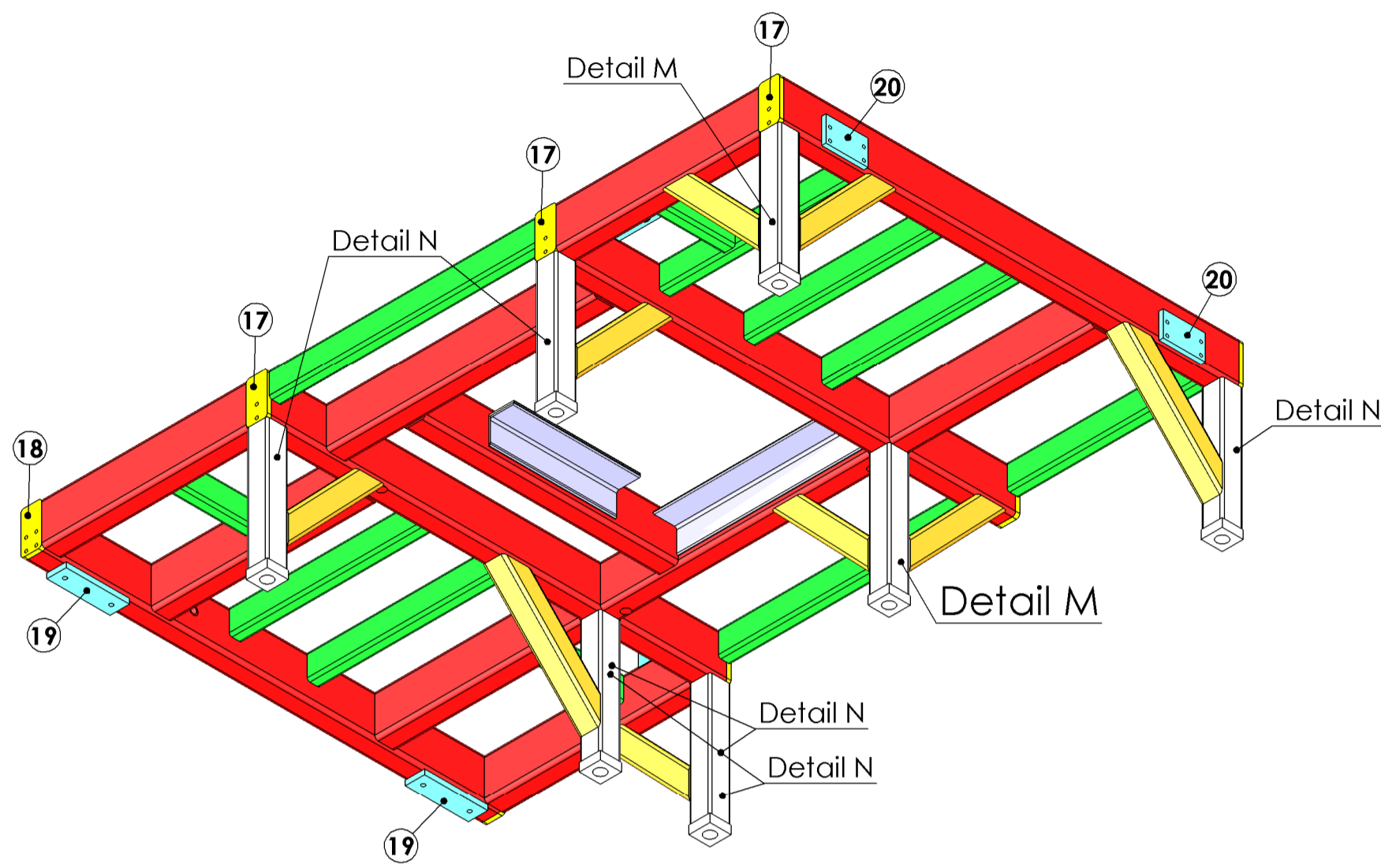
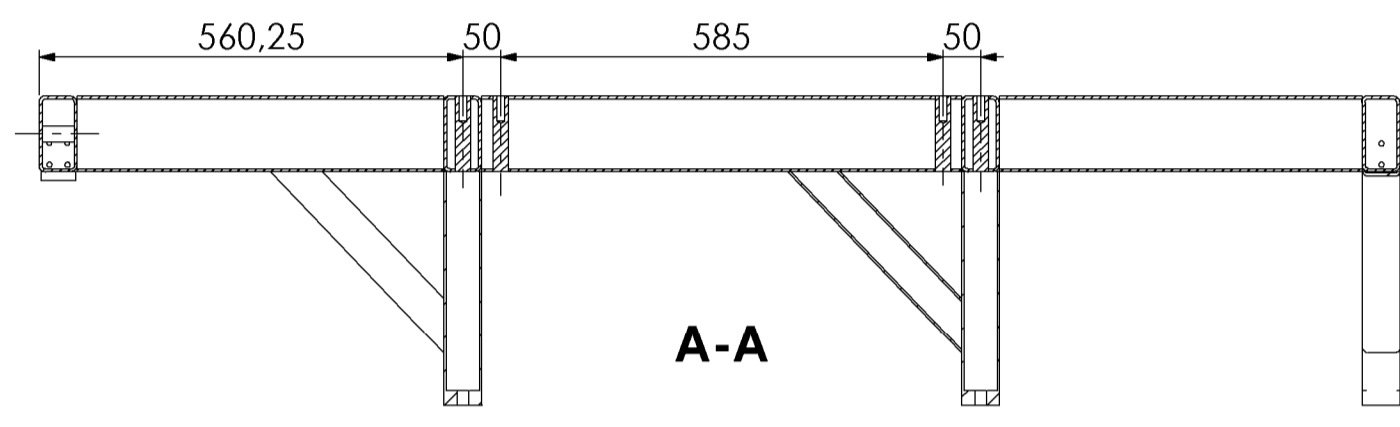
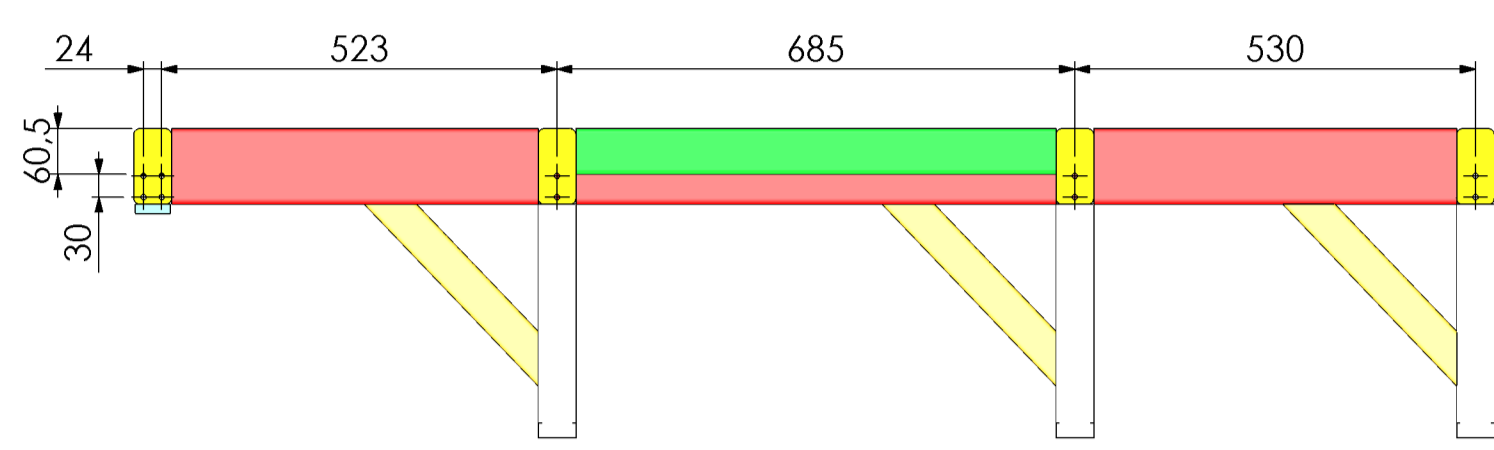
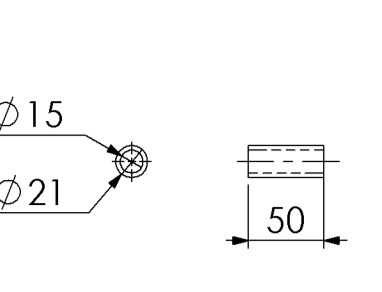

SOUDURES : A=3 CONTINUE ETANCHE
TOLERANCE GENERALE : ± 1 mm
TOLERANCE DE PLANEITE : ± 1 mm/m
PEINTURE EPOXY EP: 60µ
COULEUR : BLANC RAL 9010

| No. | QTE | DESCRIPTION | LONG. |
|-----|-----|-------------------------------|-------|
| 1 | 1 | Tube rectangulaire 100X50X4 | 1080 |
| 2 | 1 | Tube rectangulaire 100X50X4 | 1080 |
| 3 | 1 | Tube rectangulaire 100X50X4 | 1080 |
| 4 | 1 | Tube rectangulaire 100X50X4 | 1080 |
| 5 | 1 | Tube rectangulaire 100X50X4 | 635 |
| 6 | 1 | Tube rectangulaire 100X50X4 | 635 |
| 7 | 1 | Tube rectangulaire 100X50X4 | 600 |
| 8 | 4 | Tube rectangulaire 100X50X4 | 485 |
| 9 | 2 | Tube rectangulaire 100X50X4 | 480 |
| 10 | 2 | Tube rectangulaire 60X30X3 | 635 |
| 11 | 2 | Tube rectangulaire 60X30X3 | 485 |
| 12 | 4 | Tube rectangulaire 60X30X3 | 480 |
| 13 | 2 | Tube rectangulaire 60X30X3 | 210 |
| 14 | 1 | Tube rectangulaire 60X30X3 | 195 |
| 15 | 2 | Cornière ailes égales 60X60X4 | 450 |
| 16 | 2 | Cornière ailes égales 60X60X4 | 300 |
| 17 | 6 | Platine 100x50x10 Detail A | |
| 18 | 2 | Platine 100x50x10 Detail B | |
| 19 | 2 | Platine 150x46x12 Detail C | 150 |
| 20 | 2 | Platine 100x60x10 Detail D | |
| 21 | 6 | Douille M12 Detail E | |
| 22 | 2 | Tube 15x21 Lg:50 Detai F | |
| 23 | 1 | Platine 150x100x6 | |
| 24 | 2 | Platine triangle 120 ep: 6 | |

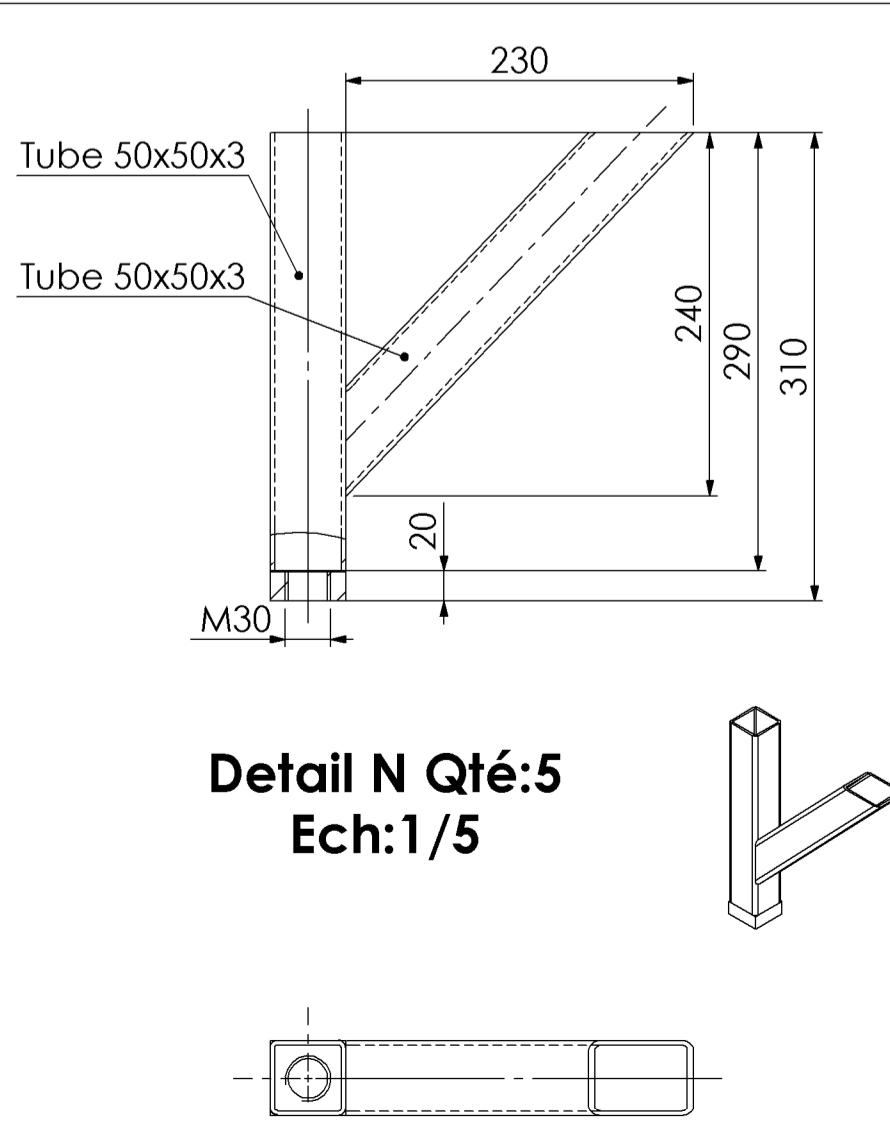
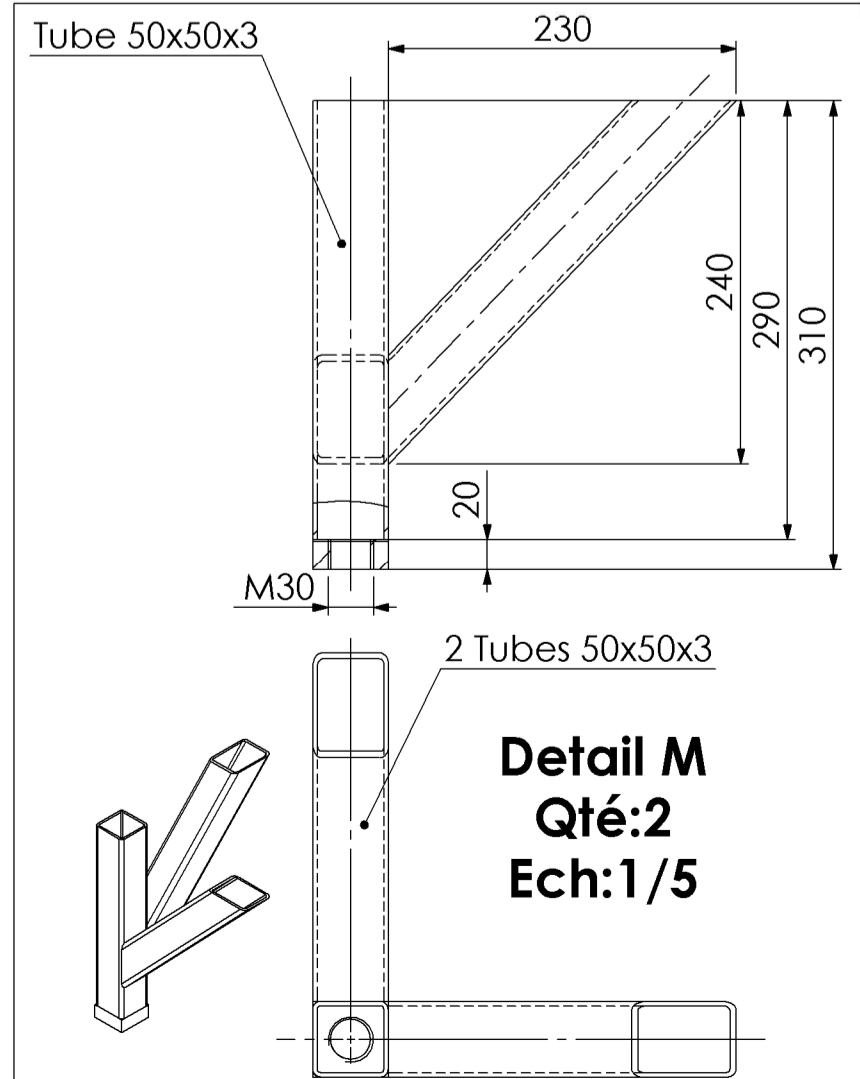
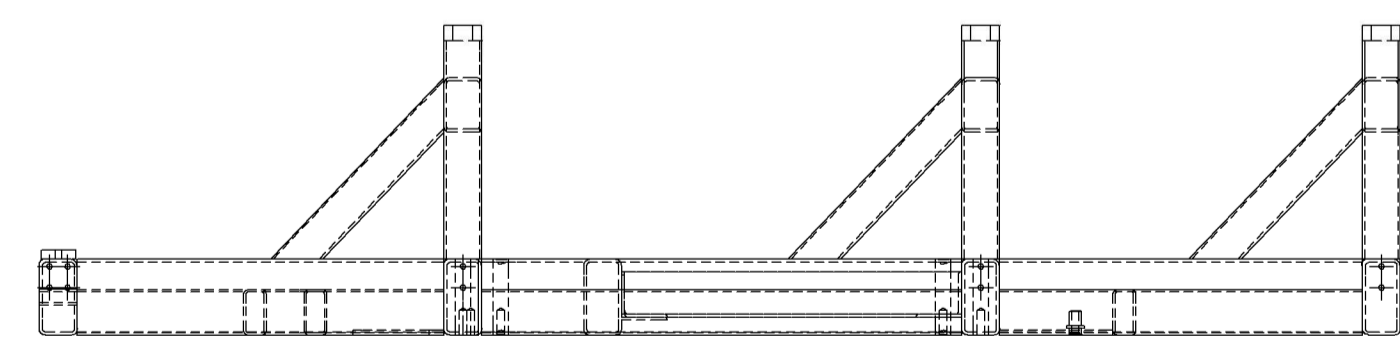

| | | |
|--|--|-----------------------|
| Ind. F | | |
| Ind. E | | |
| Ind. D | | |
| Ind. C | | |
| Ind. B | | |
| Projet : CHASSIS TEL36 | | Matière : E24-2 |
| Désignation : CHASSIS 1 | | Traitement : PEINTURE |
| | | Rug. géné.: |
| | | MASSE: 135 Kg |
| Heyman | | |
| 5 place de gardes 38000 Grenoble | | |
| Tel : 06 33 31 88 11 e-mail : heyman@design-mecanique.fr | | |
| N° de plan : TEL36-FAU-05 | | |